

# TL28

series



## Product Segments

- **Ergo Motion**

TiMOTION's TL28 series lifting columns are specifically designed for use in ergonomic desks and work tables. Using multiple TL series lifting columns with compatible TC series control boxes and TH/TDH series controls, work surfaces can be controlled quietly and smoothly with synchronous movement. All Ergo Motion TC series control boxes have a less than 0.1W standby power option that reduces power consumption. Our wide range of columns offers customers the solutions they require to satisfy their project requirements. The TL28 has a two stage telescopic outer tube that is designed for a wide-top, narrow-bottom square appearance. One single TL28 can lift maximum 80KG. Various powder coating is available.

### General Features

Maximum load	800N in push
Maximum speed at full load	28mm/s (with 800N in a push condition)
Minimum installation dimension	645mm
Stroke	500mm
Dimension of outer tube (L*W)	70*70mm
Two stage outer tube with square appearance	
Wide top and narrow bottom configuration	

**Drawing**

Standard Dimensions  
(mm)

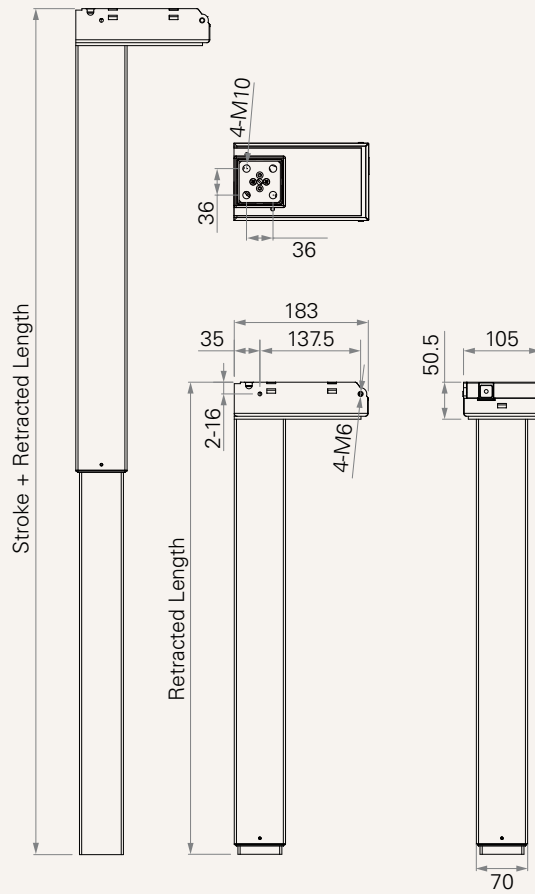

**Load and Speed**

CODE	Load (N)	Self Locking Force (N)	Typical Current (A)		Typical Speed (mm/s)	
	Push		No Load 32V DC	With Load 24V DC	No Load 32V DC	With Load 24V DC
<b>Motor Speed (5200RPM)</b>						
<b>A</b>	800	800	2.5	5.0	46.0	28.0

**Note**

- 1 This self-locking force level is reached only when a short circuit is applied on the terminals of the motor. All the TiMOTION control boxes have this feature built-in.
- 2 Parameters above are from tested average, please refer to approval drawing for final value.

Performance Data (24V DC Motor)

Motor Speed (5200RPM)

Speed vs. Load

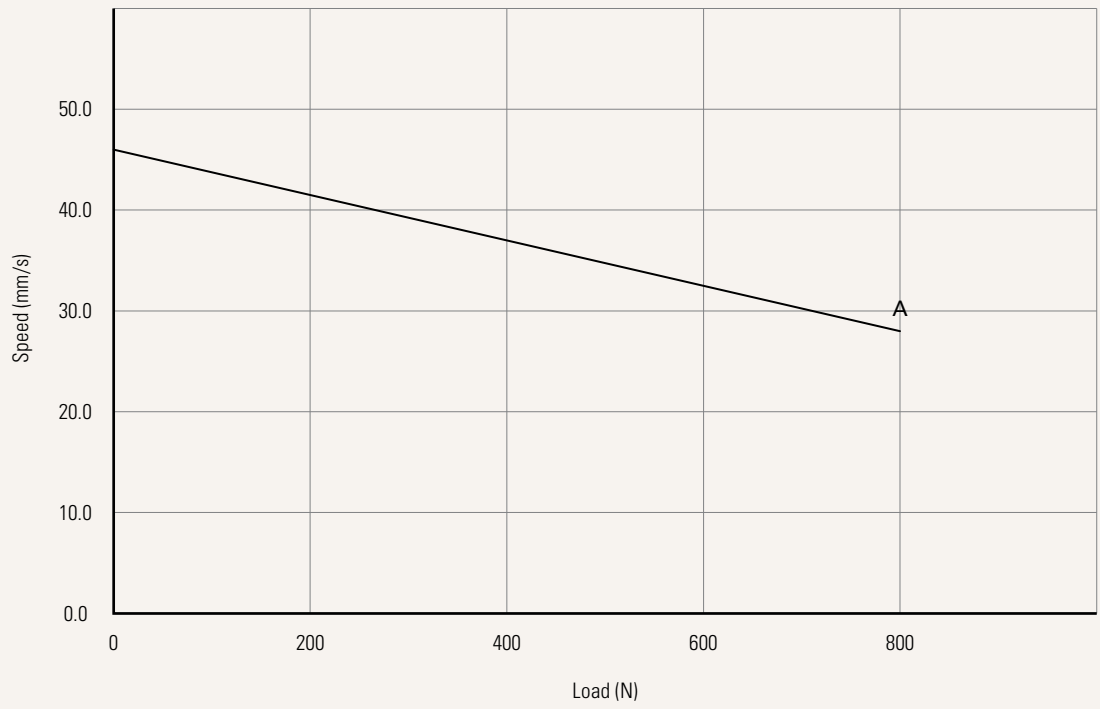

Current vs. Load

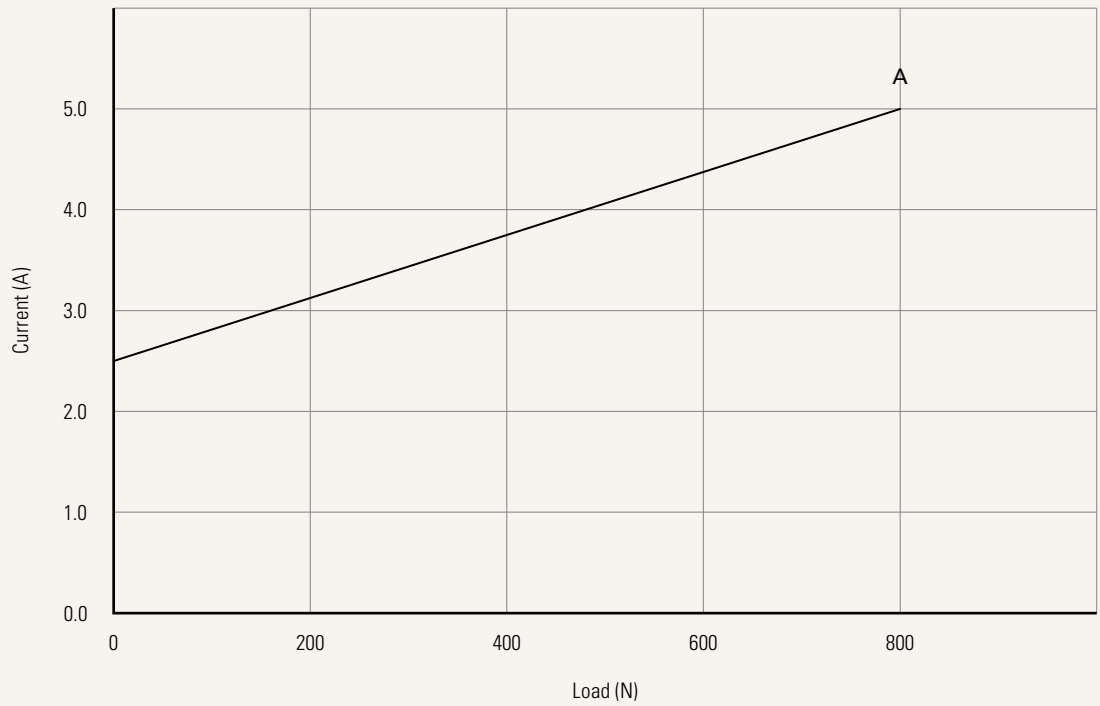

Note

1 The performance data in the curve charts shows theoretical value.

<b>Voltage</b>	2 = 24V DC	
<b>Load and Speed</b>	<a href="#">See page 2</a>	
<b>Stroke &amp; Retracted Length (mm)</b>	<a href="#">See page 5</a>	
<b>Color</b>	1 = Black, RAL 9005, Black wiper 2 = Grey, RAL 9006, Black wiper 3 = White, RAL 9016, Black wiper 4 = Special grey, RAL 9022, Black wiper	6 = Grey, RAL 9006, Grey wiper 7 = White, RAL 9016, White wiper 8 = Special grey, RAL 9022, Grey wiper B = Matte black, RAL 7021, Black wiper
<b>Motor Housing Step</b>	0 = With	1 = Without
<b>Output Signals</b>	2 = Two Hall sensors	
<b>Connector</b> <a href="#">See page 5</a>	1 = DIN 6P, 90° plug E = Molex 8P, plug, standard	
<b>Cable Length (mm)</b>	1 = Straight, 500	4 = Straight, 1500
<b>Welding Part</b>	0 = Without	

### Note

<sup>1</sup> The TL28 is designed especially for push applications, not suitable for pull applications.

---

## Stroke & Retracted Length (mm)

---

### A. Stroke & Retracted Length

500 / 645

---

---

## Connector

1 = DIN 6P, 90° plug

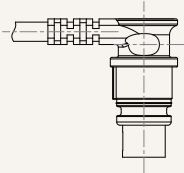

E = Molex 8P, plug, standard

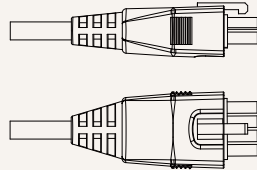

---

## Terms of Use

The user is responsible for determining the suitability of TiMOTION products for a specific application. TiMOTION products are subject to change without prior notice.